

REPAIR PARTS

BY: JAR DATE: 01-19-12
CHK: JAR REV: 01-13-22

FITTING NO.
SEE SCHEDULE
SUBMITTED MODEL NO.

ITEM NO.

FOR TECHNICAL ASSISTANCE
1-800-TEC-TRUE (1-800-832-8783)

SCHEDULE	SCHEDULE
FITTING NO.	FITTING NO.
3502-E39VPABCP	3502-E2805ABCP
3502-4E39VPABCP	3502-4E2805ABCP
3502-8E39VPABCP	3502-8E2805ABCP

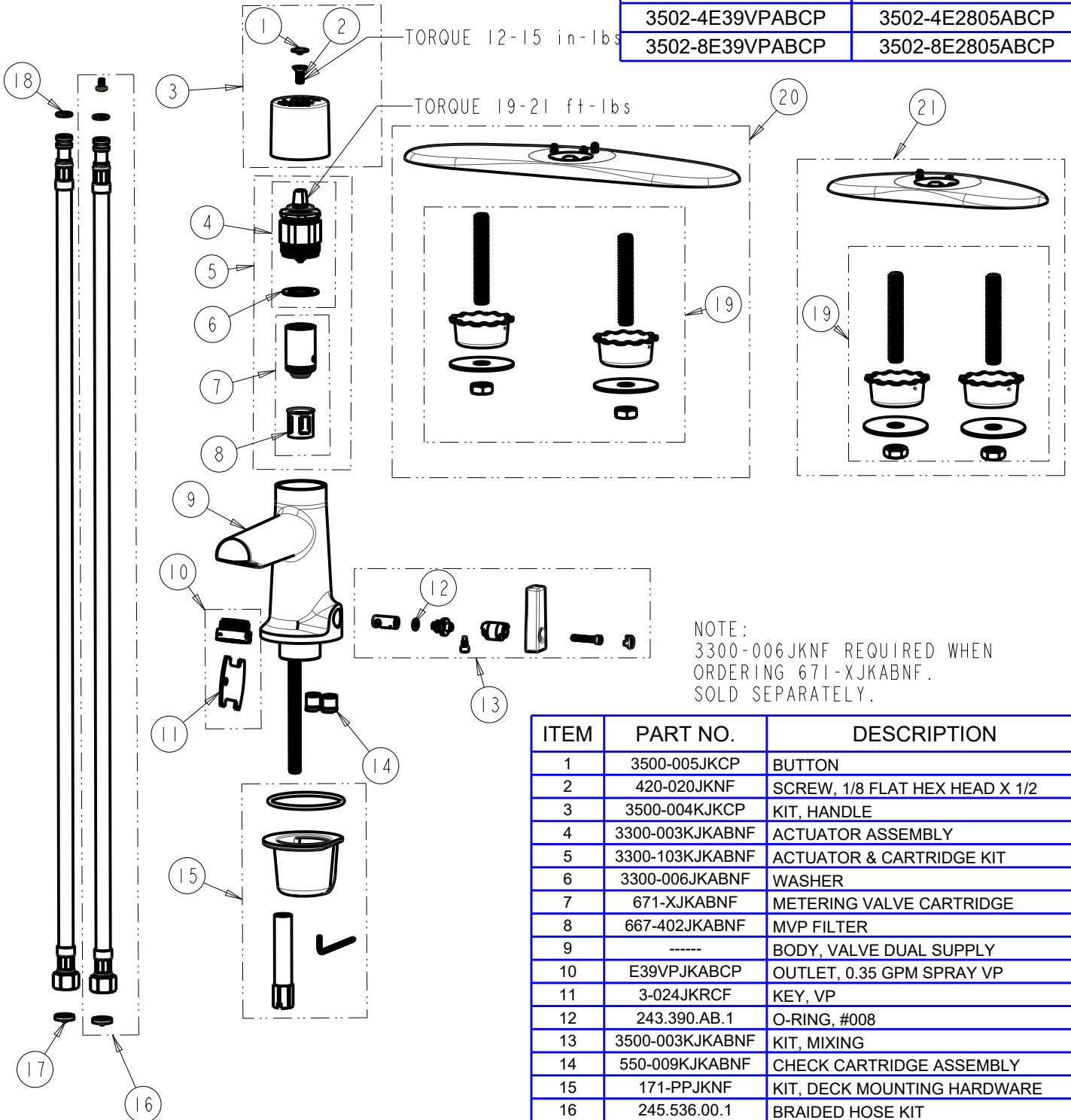

ITEM	PART NO.	DESCRIPTION
1	3500-005JKCP	BUTTON
2	420-020JKNF	SCREW, 1/8 FLAT HEX HEAD X 1/2
3	3500-004JKKCP	KIT, HANDLE
4	3300-003KJKABNF	ACTUATOR ASSEMBLY
5	3300-103KJKABNF	ACTUATOR & CARTRIDGE KIT
6	3300-006JKABNF	WASHER
7	671-XJKABNF	METERING VALVE CARTRIDGE
8	667-402JKABNF	MVP FILTER
9	-----	BODY, VALVE DUAL SUPPLY
10	E39VPJKABCP	OUTLET, 0.35 GPM SPRAY VP
11	3-024JKRCF	KEY, VP
12	243.390.AB.1	O-RING, #008
13	3500-003KJKABNF	KIT, MIXING
14	550-009KJKABNF	CHECK CARTRIDGE ASSEMBLY
15	171-PPJKNF	KIT, DECK MOUNTING HARDWARE
16	245.536.00.1	BRAIDED HOSE KIT
17	3300-205JKABNF	FILTER SCREEN, 50 MESH
18	243.392.AB.1	O-RING, #011
19	242.872.21.1	KIT, COVER PLATE MOUNTING
20	3500-002JKKCP	KIT, COVER PLATE 8 IN
21	3500-001JKKCP	KIT, COVER PLATE 4 IN