

**CHICAGO
FAUCETS** 

a Geberit company

FOR TECHNICAL ASSISTANCE
1-800-TEC-TRUE (1-800-832-8783)

2100 South Clearwater Drive
Des Plaines, IL 60018
Phone: 847-803-5000
Fax: 847-803-5454
www.chicagofaucets.com

**REPAIR
PARTS**

BY: JAR DATE: 09-11-09

CHK:  REV: 10-20-14

FITTING NO.

927-SAM

SUBMITTED MODEL NO.

ITEM NO.

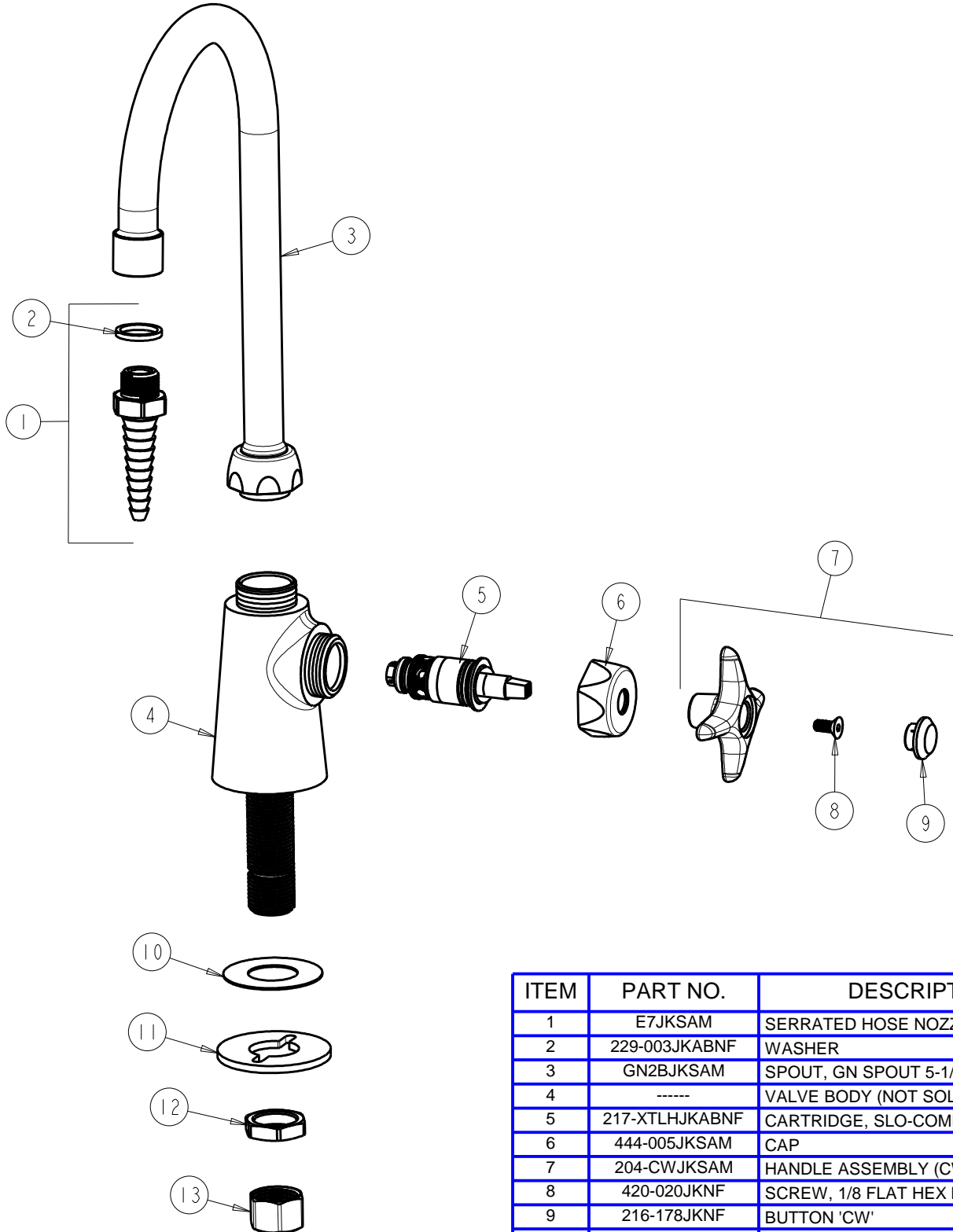

ITEM	PART NO.	DESCRIPTION
1	E7JKSAM	SERRATED HOSE NOZZLE
2	229-003JKABNF	WASHER
3	GN2BJKSAM	SPOUT, GN SPOUT 5-1/4" C-C
4	-----	VALVE BODY (NOT SOLD SEPARATELY)
5	217-XTLHJKABNF	CARTRIDGE, SLO-COMPRESSION (LH)
6	444-005JKSAM	CAP
7	204-CWJKSAM	HANDLE ASSEMBLY (CW)
8	420-020JKNF	SCREW, 1/8 FLAT HEX HEAD X 1/2
9	216-178JKNF	BUTTON 'CW'
10	333-103JKNF	RUBBER WASHER
11	807-112JKNF	WASHER
12	49-004JKRBF	LOCKNUT
13	49-005JKRBF	COUPLING NUT