

ROUGHING IN DIMENSIONS MAY VARY AND ARE SUBJECT TO CHANGE. NO RESPONSIBILITY IS ASSUMED FOR USE OF SUPERCEDED OR VOIDED DATA.

CHICAGO FAUCETS
a Geberit company

2100 South Clearwater Drive
Des Plaines, IL 60018
Phone: 847-803-5000
Fax: 847-803-5454
www.chicagofaucets.com

FOR TECHNICAL ASSISTANCE
1-800-TEC-TRUE (1-800-832-8783)

ROUGH-IN

BY: JAR

DATE: 09-06-16

CHK: *JAR*

REV:

FITTING NO.

3300-402JKCP

SUBMITTED MODEL NO.

SUBMITTED AS SHOWN

SUBMITTED AS NOTED

SEE ATTACHED FOR
SUBMITTED MODIFICATION

JOB NAME

ITEM NO.

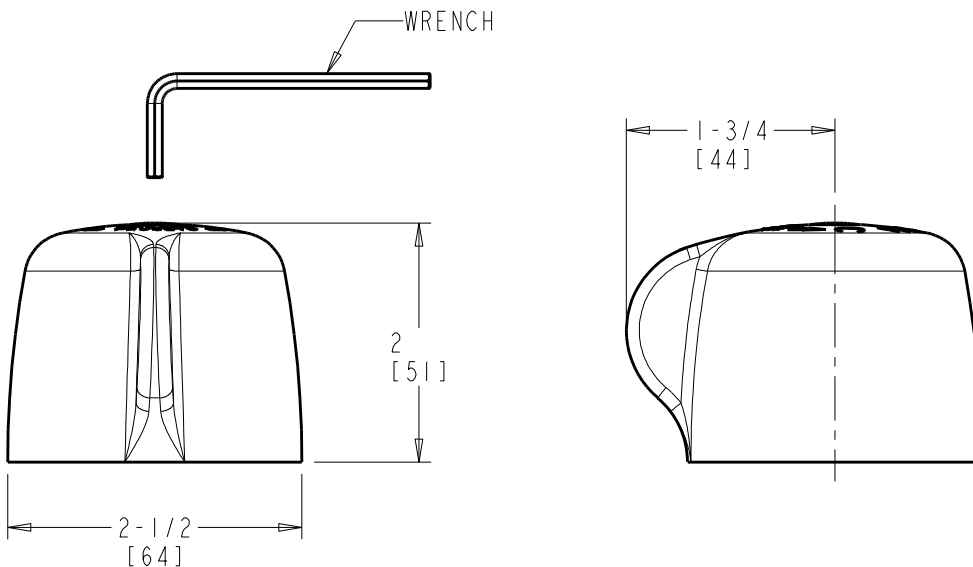
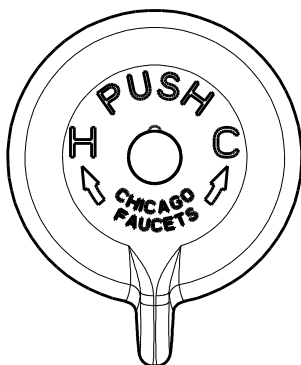

DIMENSIONS ARE IN INCHES AND [MILLIMETERS].

TECHNICAL DATA

- SINGLE HANDLE
- CHROME BUTTON
- VANDAL RESISTANT HEX SCREW
- 1/8" HEX WRENCH
- FINISH: CHROME PLATE

- ADA ANSI/CC A117.1 COMPLIANT



ADA COMPLIANT